

cedar sales

Panelling OPTIONS



Vee Joint



shiplap



flat panel



ALTACHE[®]
Panel



ALTACHE[®]
Fineline



P: 07 3281 4222
F: 07 3281 4322
E: info@cedarsales.com.au

Western Red Cedar from sustainable managed resources.

Photo courtesy of Adenbrook Homes

cedar sales

**Why Western Red Cedar?
Stays Straight!**

Vee Joint Panelling



Vee Joint

Western Red Cedar panelling is exceptionally stable and can be installed with ease.

Vee-Joint profile is widely used in many applications, showing a vee groove where individual boards join.

Installation details on Page 11.

For Trim Products - see Cedar Sales Product Catalogue

Vee Joint in Western Red Cedar Key: RTO = Run to Order

Profile	Cover (mm)	Thickness (mm)	Stock Item (Raw)	Stock Item (Prefinished)	Ceiling Spans (mm)	Boards per Bundle	Available in Hemlock	Cad Drawing
VJM 133x15	133	15	✓	RTO	600	7		
VJM 86x15	86	15	✓	RTO	600	10		
DS VJS 133x12	133	12	✓	RTO	600	8	RTO	
VJS 86x12	86	12	✓	RTO	600	12	RTO	
VJI 140x9	140	9	✓	✓	450	10	RTO	
VJI 89x9	89	9	✓	✓	450	15	RTO	

cedar sales

Why Cedar?
Good Thermal Properties!

shiplap *Panelling*



Photo courtesy of Adenbrook Homes

shiplap & *shiplap_{Regency}* in Western Red Cedar Key: RTO = Run to Order

Profile	Cover (mm)	Thickness (mm)	Stock Item (Raw)	Stock Item (Prefinished)	Ceiling Spans (mm)	Boards per Bundle	Available in Hemlock	Cad Drawing
SLM 133x15	133	15	✓	RTO	600	7		
SLM 82x15	82	15	✓	RTO	600	10		
SLS 133x12	133	12	✓	RTO	600	8	RTO	
SLI 133x9	133	9	✓	✓	450	10		
SLI 82x9	82	9	✓	RTO	450	15		
SLI 133Rx9	133	9	✓	RTO	450	10		
SLI 82Rx9	82	9	✓	RTO	450	15		

eased edge *shiplap* in Western Red Cedar Key: RTO = Run to Order

EEM 133x15	133	15	✓	RTO	600	7		
EEM 86x15	86	15	✓	RTO	600	10		
DS EES 133x12	133	12	✓	RTO	600	8	RTO	

Western Red Cedar shiplap

panelling boasts a shiplap channel effect widely used in contemporary design. All shiplap profiles have generous secret nail fixing points.

Eased Edge Shiplap has a more subtle touch and provides weather run off when used in horizontal external applications.

Installation details on Page 11.

For Trim Products - see Cedar Sales Product Catalogue

Why Western Red Cedar?
Long Lasting!

ALTACHÉ[®] Panel

**Why Cedar?
Stability!**

cedar sales

PATENT PENDING

ALTACHÉ[®] Panel

Feature panelling par excellence with unlimited potential for satisfying design and feature requirements.

Altaché Panel (12mm thickness) features an 18mm strip of anodised aluminium. The timber panel can be supplied prefinished in a clear satin coating. The product has provision for concealed fixing by nail gun or flat pan head self tapping screws.

Installation details on Page 11.

For Trim Products - see Cedar Sales Product Catalogue

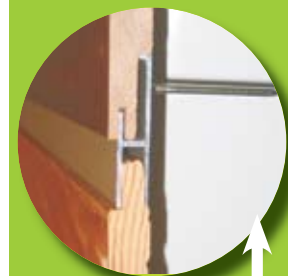

Altaché Panel in Western Red Cedar

Key: RTO = Run to Order

Profile	Cover (mm) Including Aluminium	Thickness (mm)	Timber Face Exposed (mm)	Aluminium Face Exposed (mm)	Stock Item (Raw)	Stock Item (Prefinished)	Ceiling Spans (mm)	Available in Hemlock	Available with Clear Anodised Aluminium	Available with Black Anodised Aluminium	Cad Drawing
AP 147 x 12	147	12	129	18	✓	RTO	600	RTO	✓	✓	
AP 97 x 12	97	12	79	18	✓	RTO	600	RTO	✓	✓	

Note: Aluminium Profile supplied packaged with timber panel

cedar sales



**Why Western Red Cedar?
It's Durable!**



PATENT PENDING



Another Altaché feature panelling system (10mm thickness) with a subtle 8mm fineline of anodised aluminium giving a demarcation between the rich natural tones of Western Red Cedar panelling.

Altaché Fineline is available in clear satin finish and with provision for concealed fixing by nail gun or flat pan head, self tapping screws.

Installation details are available.

For Trim Products - see Cedar Sales Product Catalogue



Altaché Fineline Sliding Door System

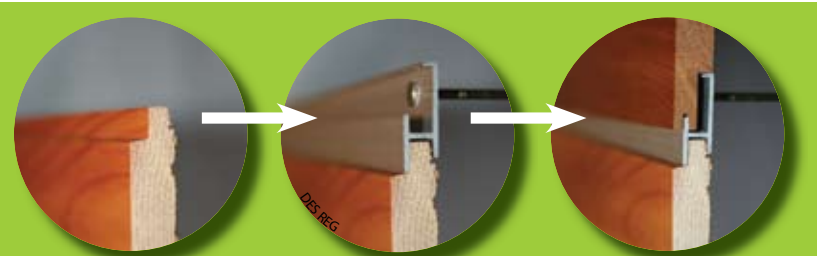

Altaché Fineline in Western Red Cedar

Key: RTO = Run to Order

Profile	Cover (mm) Including Aluminium	Thickness (mm)	Timber Face Exposed (mm)	Aluminium Face Exposed (mm)	Stock Item (Raw)	Stock Item (Prefinished)	Ceiling Spans (mm)	Boards per Bundle	Available in Hemlock	Available with Clear Anodised Aluminium	Available with Black Anodised Aluminium	Cad Drawing
AF 142 x 10	142	10	134	8	✓	✓	450	10	✓	✓	✓	
AF 92 x 10	92	10	84	8	✓	✓	450	15	✓	✓	✓	

Note: Aluminium Profile supplied packaged with timber panel

Why Cedar?
Long Lasting!

flatt panel

New Release

Prefinished Panelling

- NO FUSS
- NO BRUSH
- NO MESS
- NO DROPSHEETS
- NO SCAFFOLDING
- NO DOWN TIME
- NO EXTRA LABOUR

Some panelling products are now available (as specified in product charts) in prefinished, satin, long lasting, quality finishes for out of weather applications.

Installation Guide

Preparation:

Wall or Ceiling surfaces must be prepared so panelling can be fixed at maximum 600mm (preferably 450mm) centres. Significantly uneven wall surfaces should be rectified with the aid of a stringline, by packing out and nailing 42mm x 19mm soft wood battens.

Fixing:

Panelling is to be installed using adhesive, applied with a caulking gun and stainless, brass or cadmium plated brads or pin gun nails.

Apply adhesive to the studs, noggings or battens, (whichever is applicable), or to the panelling so the boards are glued completely across their width, taking care not to allow glue into the tongue and groove joints.

Punch nails flush as shown to avoid obstructing the next board.

shiplap

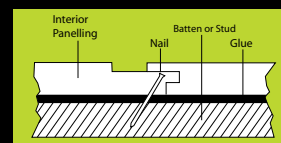

vee joint

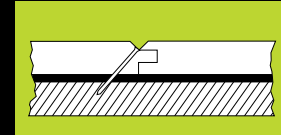

ALTAQIE® Panel

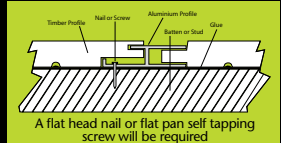

Installation Hints:

- Prior to fixing, lay out boards to achieve the desired effect.
- Check if corrective action is needed to compensate for non-parallel floor and ceiling (or adjoining walls).
- Make sure the first board is laid exactly horizontal (with spirit level), vertical (with level or plumb), or diagonal as desired. As you proceed, check each board is parallel with the first board and that each board fits snugly with the preceding one.
- Where abnormal or extreme atmospheric conditions exist 4. (very dry, very hot or humid), unpack the boards and allow them to acclimatize for a few days.
- When sanding the boards always sand the entire length of the board. (If only part of a board is sanded, when the entire board is coated the sanded portion will show up slightly different colour).
- Installation in any external applications will require the ends to be sealed.

Western Red Cedar flatt panel

A new inspiring design which forsakes past traditional profiling and provides a flatt panel effect with a minute shadow line joint to satisfy design opportunities in modern trends.

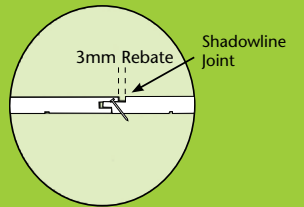

flatt panel in Western Red Cedar

Key: RTO = Run to Order

Profile	Cover (mm)	Thickness (mm)	Stock Item (Raw)	Stock Item (Prefinished)	Ceiling Spans (mm)	Boards per Bundle	Available in Hemlock	Cad Drawing
FPI 133 x 9	133	9	✓	RTO	450	10	RTO	
FPI 82 x 9	82	9	✓	RTO	450	15	RTO	

**Why Western
Red Cedar?**
From Sustainable
Managed Resources



Distributed by:

